

Model 1620

Stand-assist

A quick solution for toilet transfers



SUREHANDS®



- For a quick transfer from seat to seat
- Highly mobile and compact
- Exchangeable battery box with integrated charger
- Adjustable knee support
- Emergency operation
- Safety belt for lower legs



Lift & Care systems for people with reduced mobility

www.surehands.com

● Dimensions and specifications

A.....	Max. height	66.5 in. / 1690 mm
B.....	Min. height	42.1 in. / 1070 mm
C.....	Mast Height	29.1 in. / 740 mm
D.....	Base height	4.3 in. / 110 mm
E.....	Max. base width	36.2 in. / 920 mm
F.....	Min. base width	25 in. / 635 mm
G.....	Base length	38.9 in. / 990 mm
H.....	Caster height	3.9 in. / 100 mm

Safe working load	330.7 Lbs / 150 kg
Batteries	2 x 12 volt 2.9 ah rechargeable
Charger - input	220/230 V AC
Charger - output	27.4/29.0 V DC
Weight	94.8 Lbs / 43.5 kg
Emergency down	mechanical
Number of lifts with fully charged batteries	40

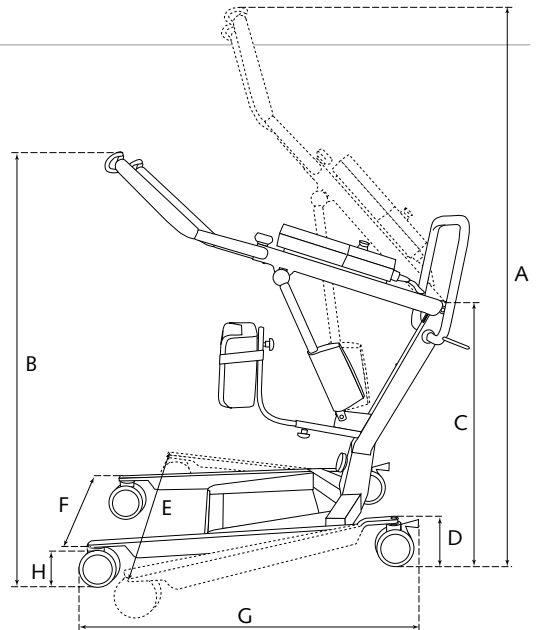

● Active sling

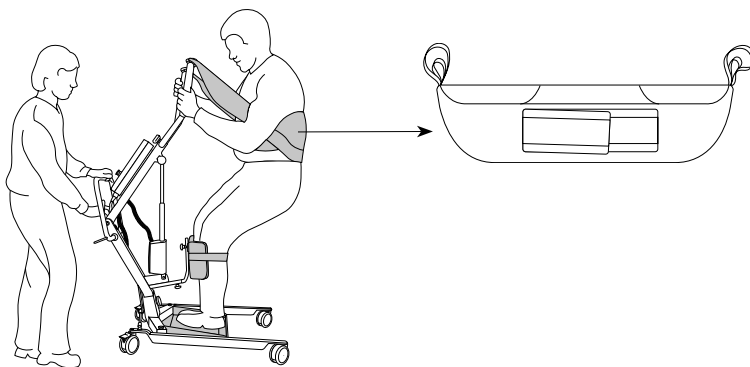

● Control box and removable battery box

A.....	Removable batterybox
B.....	Emergency switch
C.....	Battery status indicator (LCD)
D.....	Electrical emergency controls
E.....	Charging procedure indicator led
F.....	Charger current indicator led

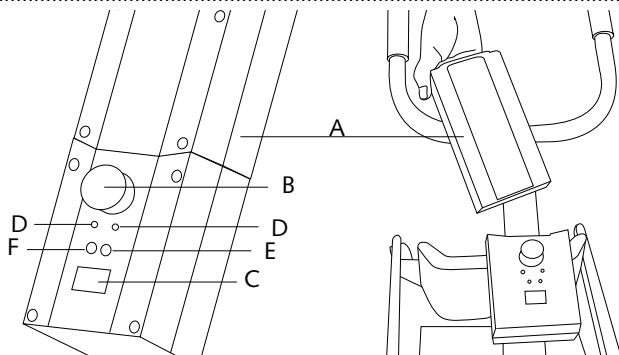

Local Representative

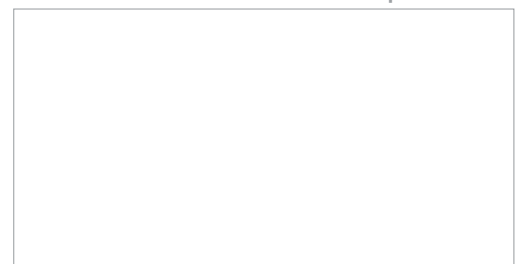

Lift & Care® is a registered trademark of T.F. Herceg, Inc. dba SUREHANDS LIFT & CARE SYSTEMS.

© 20-08-2015 • Handi-Move • v2.1